

**4 - Bolt Flange Blocks - Setscrew Locking**

Series	Bearing Inner Ring	Housing	Housing Duty	Shaft Diameter		Page
				Inch	MM	
UCF	Wide	Square	Standard	1/2 - 3	12 - 75	26
UCFS	Wide	Square	Standard	1/2 - 2 7/16	12 - 60	27
UCFX	Wide	Square	Medium	7/8 - 3	-	28
SBF	Narrow	Square	Standard	1/2 - 1 1/2	-	29
SBFS	Narrow	Square	Light	3/4 - 1 1/2	-	30
SBFN	Narrow	Square	Light	1/2 - 1 3/4	-	31
UCFC	Wide	Round Cartridge	Standard	1/2 - 2 1/2	-	32

**4 - Bolt Flange Blocks - Eccentric Locking Collar**

Series	Bearing Inner Ring	Housing	Housing Duty	Shaft Diameter		Page
				Inch	MM	
HCFS	Wide	Square	Standard	3/4 - 2 7/16	20 - 60	33
SAF	Narrow	Square	Standard	1/2 - 1 1/2	-	34
SAFS	Narrow	Square	Standard	3/4 - 1 1/2	-	35
SAFN	Narrow	Square	Light	1/2 - 1 3/4	-	36

**3 - Bolt Flange Blocks - Ductile Iron Housing**

Series	Bearing Inner Ring	Locking type	Housing Duty	Shaft Diameter		Page
				Inch	MM	
SBFCT	Narrow	Set Screw	Light	1/2 - 1 7/16	-	37
SAFCT	Narrow	Eccentric Collar	Light	1/2 - 1 7/16	-	38

**Screw Conveyor Hanger Unit**

Series	Bearing Inner Ring	Locking type	Housing Duty	Shaft Diameter		Page
				Inch	MM	
UCSH	Wide	Set Screw	Threaded Base	1/2 - 2	-	39

**Take- Up Units - Wide Slot**

Series	Bearing Inner Ring	Locking type	Housing Duty	Shaft Diameter		Page
				Inch	MM	
UCST	Wide	Set Screw	Standard	1/2 - 2 1/2	12 - 65	40
HCST	Wide	Eccentric Collar	Standard	1/2 - 2 7/16	20 - 60	41

**Rubber Mounted - Cylindrical Cartridge**

Series	Bearing Inner Ring	Locking type	Housing	Shaft Diameter		Page
				Inch	MM	
RCSMS	Narrow	Set Screw	Rubber Grommet	1/2 - 1	-	42
RCSM	Narrow	Eccentric Collar	Rubber Grommet	1/2 - 1	-	42

**Rubber Mounted - Spherical Cartridge**

Series	Bearing Inner Ring	Locking type	Housing	Shaft Diameter		Page
				Inch	MM	
SBR	Narrow	Set Screw	Rubber Grommet	1/2 - 1 1/4	-	43
SAR	Narrow	Eccentric Collar	Rubber Grommet	1/2 - 1 1/4	-	43

**3 Bolt Flange \* Narrow Inner Ring Bearing \* Set Screw Locking  
Ductile Iron Housing \* Relubricatable with Anti-Rotation Pin**

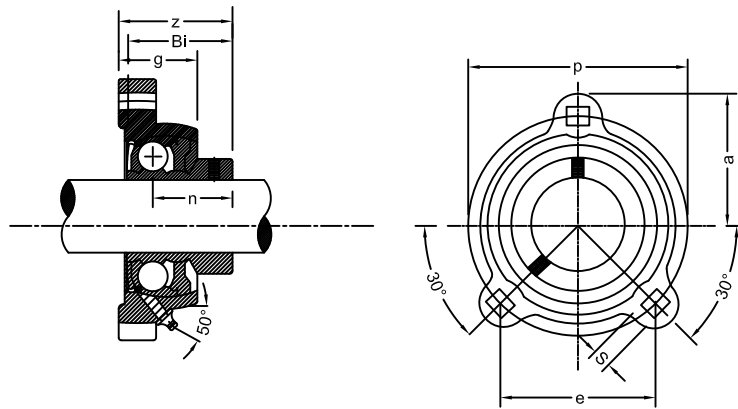

Unit no.	Shaft Dia.	Dimensions (Inch)								Bolt Size Inch	Bearing No.	Housing No.	Weight lbs.
	Inch	a	p	e	g	z	S	Bi	n				
SBFCT201-8	1/2	1 19/32	2 1/2	2.165	11/16	1 1/64	9/32	0.8661	0.236	1/4	SB201-8	FCT203	0.46
SBFCT202-10	5/8										SB202-10		
SBFCT204-12	3/4	1 25/32	2 13/16	2.436	25/32	1 9/64	11/32	0.9843	0.275	5/16	SB204-12	FCT204	0.71
SBFCT205-14	7/8	1 7/8	3	2.598	25/32	1 11/64	11/32	1.0630	0.295	5/16	SB205-14	FCT205	0.82
SBFCT205-15	15/16										SB205-15		
SBFCT205-16	1										SB205-16		
SBFCT206-17	1 1/16	2 7/32	3 9/16	3.085	7/8	1 11/32	13/32	1.1811	0.315	3/8	SB206-17	FCT206	0.73
SBFCT206-18	1 1/8										SB206-18		
SBFCT206-19	1 3/16										SB206-19		
SBFCT206-20	1 1/4										SB206-20		
SBFCT207-20	1 1/4	2 13/32	3 15/16	3.410	15/16	1 7/16	13/32	1.2598	0.335	3/8	SB207-20	FCT207	1.57
SBFCT207-21	1 5/16										SB207-21		
SBFCT207-22	1 3/8										SB207-22		
SBFCT207-23	1 7/16										SB207-23		

**3 Bolt Flange \* Narrow Inner Ring Bearing \* Eccentric Locking Collar  
Ductile Iron Housing \* Relubricatable with Anti-Rotation Pin**

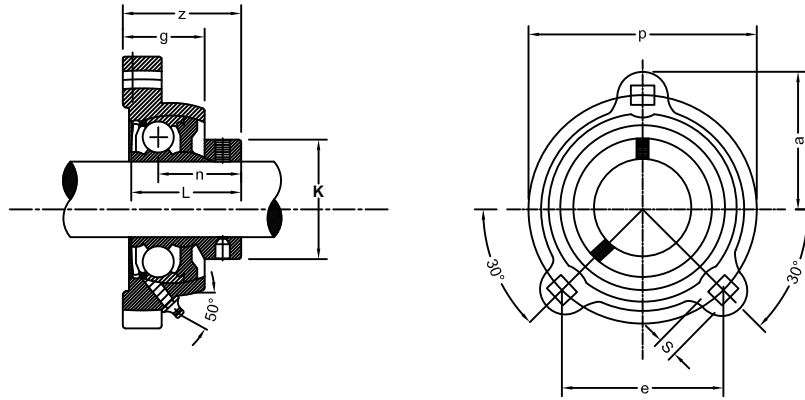

Unit no.	Shaft Dia.	Dimensions (Inch)									Bolt Size Inch	Bearing No.	Housing No.	Weight lbs.
	Inch	a	p	e	g	z	S	L	n	K				
SAFCT201-8	1/2	1 19/32	2 1/2	2.165	11/16	1 1/4	9/32	1.125	0.256	1 1/8	1/4	SA201-8	FCT203	0.57
SAFCT202-10	5/8	1 25/32	2 13/16	2.436	25/32	1 11/32	11/32	1.218	0.295	1 1/4	5/16	SA202-10	FCT204	0.75
SAFCT204-12	3/4	1 7/8	3	2.598	25/32	1 11/64	11/32	1.218	0.295	1 1/2	5/16	SA204-12	FCT205	0.86
SAFCT205-14	7/8	2 7/32	3 9/16	3.085	7/8	1 17/32	13/32	1.406	0.354	1 3/4	3/8	SA205-14	FCT206	1.35
SAFCT205-15	15/16	2 13/32	3 15/16	3.410	15/16	1 21/32	13/32	1.531	0.374	2 3/16	3/8	SA205-15	FCT207	1.81
SAFCT205-16	1	2 13/32	3 15/16	3.410	15/16	1 21/32	13/32	1.531	0.374	2 3/16	3/8	SA205-16	FCT207	1.81
SAFCT206-17	1 1/16	2 13/32	3 15/16	3.410	15/16	1 21/32	13/32	1.531	0.374	2 3/16	3/8	SA206-17	FCT207	1.81
SAFCT206-18	1 1/8	2 13/32	3 15/16	3.410	15/16	1 21/32	13/32	1.531	0.374	2 3/16	3/8	SA206-18	FCT207	1.81
SAFCT206-19	1 3/16	2 13/32	3 15/16	3.410	15/16	1 21/32	13/32	1.531	0.374	2 3/16	3/8	SA206-19	FCT207	1.81
SAFCT206-20	1 1/4	2 13/32	3 15/16	3.410	15/16	1 21/32	13/32	1.531	0.374	2 3/16	3/8	SA206-20	FCT207	1.81
SAFCT207-20	1 1/4	2 13/32	3 15/16	3.410	15/16	1 21/32	13/32	1.531	0.374	2 3/16	3/8	SA207-20	FCT207	1.81
SAFCT207-21	1 5/16	2 13/32	3 15/16	3.410	15/16	1 21/32	13/32	1.531	0.374	2 3/16	3/8	SA207-21	FCT207	1.81
SAFCT207-22	1 3/8	2 13/32	3 15/16	3.410	15/16	1 21/32	13/32	1.531	0.374	2 3/16	3/8	SA207-22	FCT207	1.81
SAFCT207-23	1 7/16	2 13/32	3 15/16	3.410	15/16	1 21/32	13/32	1.531	0.374	2 3/16	3/8	SA207-23	FCT207	1.81